

Stainless Steel

SUS 310S



Excellent performance in acid resistance, alkali resistance and heat resistance. Heat resistance are more preeminent than SUS304.

Use a combustion chamber, parts of a furnace, parts of engine and etc.

Chemical composition

C	Si	Mn	P	S	Ni	Cr
0.08 max	1.50 max	2.00 max	0.045 max	0.030 max	19.00-22.00	24.00-26.00

INDEX

	PAGE
HEX HEAD CAP SCREW	2
HEX NUT, JIS type 1	3
HEX NUT, JIS type 3	3
HEX NUT, height 1xd	4
ROUND WASHER	4



This mark means "do not contain materials limited of RoHS Directive".
(Lead / Cadmium / Mercury / 6 Chromium / PBB / PBDE)



HIGH SPEED & HIGH QUALITY

SAIMA CORPORATION

HEX HEAD CAP SCREW JIS B1180 appendix

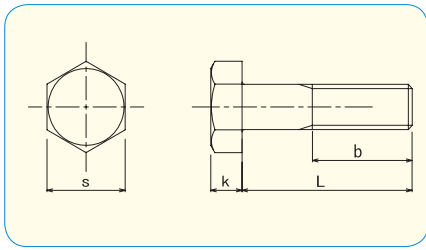

● Material
SUS 310S
 Stainless Steel



	M6	M8	M10	M12	M16	M18	M20	M22	M24	M30
s	10	13	17	19	24	27	30	32	36	46
k	4	5.5	7	8	10	12	13	14	15	19

		pcs / Box									
L \ d	M6	M8	M10	M12	M16	M18	M20	M22	M24	M30	
10	50										
12	50	50									
15	50	50									
16	50	50	30								
20	50	50	30	30							
25	50	50	30	30	20						
30	50	50	30	30	20						
35	50	50	30	30	20						
40	50	50	* 30	* 30	20	20	20				
45	50	50	* 30	* 30	20	20	20				
50	50	50	* 30	* 30	* 20	20	20	20			
55		* 50	* 30	* 30	* 20		20	20			
60	50	* 50	* 30	* 30	* 20	* 20	* 20	* 20	20	20	
65		* 50	* 30	* 30	* 20		* 20	* 20	20	20	
70	50	* 50	* 30	* 30	* 20	* 20	* 20	* 20	* 20	20	
75		* 50	* 30	* 30	* 20		* 20	* 20	* 20	20	
80		* 50	* 30	* 30	* 20	* 20	* 20	* 20	* 20	* 20	
85		* 50			* 20		* 20	* 20	* 20	* 20	
90		* 50	* 30	* 30	* 20	* 20	* 20	* 20	* 20	* 20	
100		* 50	* 30	* 30	* 20	* 20	* 20	* 20	* 20	* 20	
110			* 30	* 30	* 20		* 20	* 20	* 20	* 20	
120			* 30	* 30	* 20		* 20	* 20	* 20	* 20	
130			* 30	* 30	* 20		* 20	* 20	* 20	* 20	
140			* 30	* 30	* 20		* 20	* 20	* 20	* 20	
150			* 30	* 30	* 20		* 20	* 20	* 20	* 20	
180					* 20		* 20		* 20	* 20	
200					* 20		* 20		* 20	* 20	

* ... Half thread

HEX NUT, JIS type 1 JIS B1181 appendix

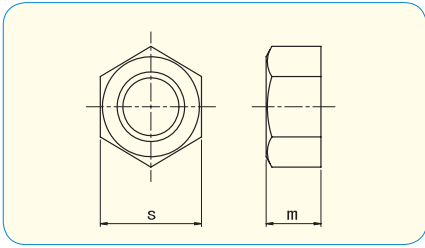

●Material
SUS 310S
 Stainless Steel

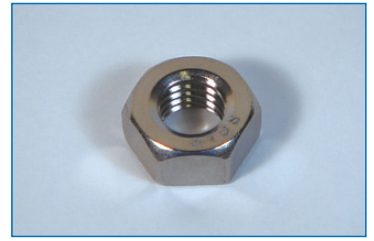

	Box q'ty	SIZE	
		s	m
M5	100	8	4
M6	100	10	5
M8	100	13	6.5
M10	100	17	8
M12	100	19	10
M14	100	22	11
M16	100	24	13
M18	100	27	15
M20	100	30	16

	Box q'ty	SIZE	
		s	m
M22	100	32	18
M24	100	36	19
M27	100	41	22
M30	100	46	24
M33	100	50	26
M36	100	55	29

HEX NUT, JIS type 3 (JAM NUT) JIS B1181 appendix

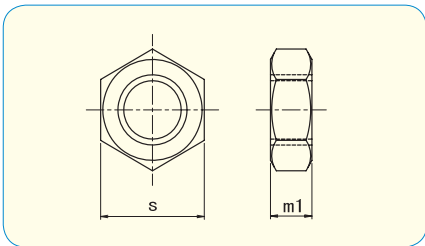

●Material
SUS 310S
 Stainless Steel



	Box q'ty	SIZE	
		s	m1
M6	100	10	3.6
M8	100	13	5
M10	100	17	6
M12	100	19	7
M14	100	22	8
M16	100	24	10
M18	100	27	11
M20	100	30	12
M22	100	32	13
M24	100	36	14
M27	100	41	16
M30	100	46	18

HEX NUT, Height 1xd

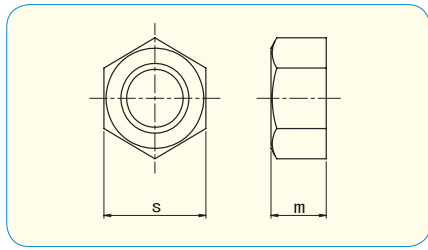

● Material
SUS 310S
 Stainless Steel



	Box q'ty	SIZE	
		s	m
M8	100	13	8
M10	100	17	10
M12	100	19	12
M14	100	22	14
M16	100	24	16
M18	100	27	18
M20	100	30	20
M22	100	32	22
M24	100	36	24

ROUND WASHER JIS B 1256

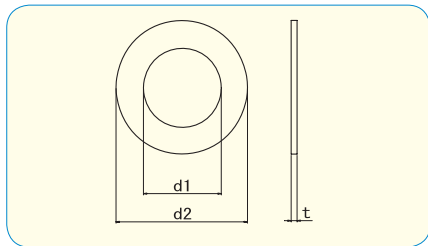

● Material
SUS 310S
 Stainless Steel



	Box q'ty	SIZE	
		d2	t
6	100	12.5	1.6
8	100	17	1.6
10	100	21	2
12	100	24	2.5
14	100	28	2.5
16	100	30	3
18	100	34	3
20	100	37	3

	Box q'ty	SIZE	
		d2	t
22	100	39	3
24	100	44	4
27	100	50	4
30	100	56	4
36	100	66	5